

KraftMaid VANTAGE®

KITCHENS FOR THE REAL LIVING ROOM™

KITCHEN GUIDEBOOK
2022-2023





KITCHEN CABINETS: Durango | Maple | Brown Sugar **NEW** ● ISLAND: Lyndale | Maple | Heron **NEW** ●

A kitchen you'll love for a lifetime.

There's a special feeling you'll get in your new kitchen. The fresh look. The flawless way everything works. How the space seems to just fit you. Decades from now, you'll feel just as good about your KraftMaid® kitchen. Because we build your cabinets to last – with skilled hands, pride and attention to detail.

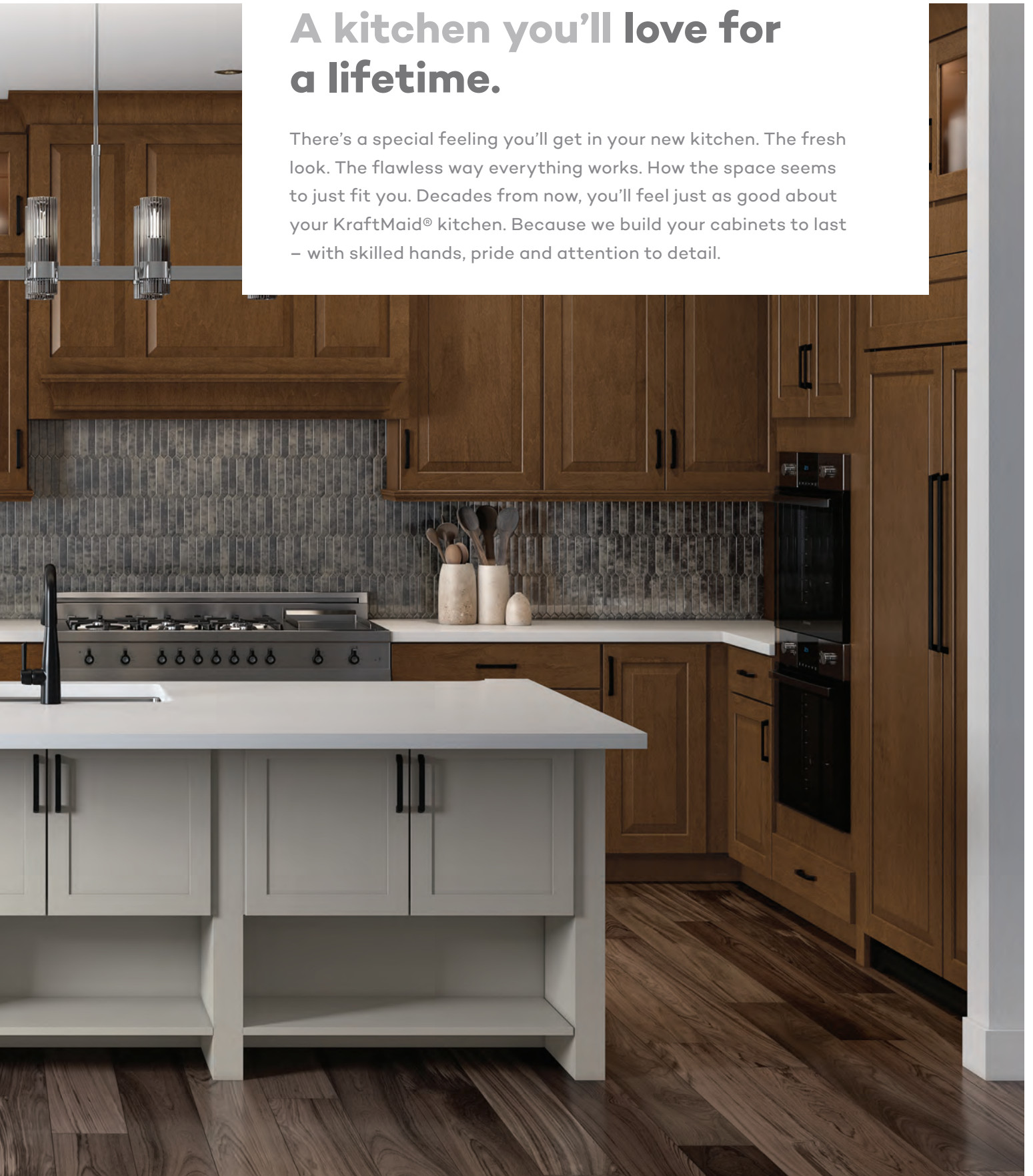

COVER IMAGE: PAINTED CABINETS: Sedona | EverCore® | Crimson **NEW** ●
STAINED CABINETS: Sedona | Hickory | Slate ●

Table of Contents



PAINTED CABINETS: Sedona | EverCore® | Crimson **NEW** ● STAINED CABINETS: Sedona | Hickory | Slate ●



Why KraftMaid®

You want everything to be perfect.
So do we.

- ▶ Craftsmanship
- ▶ Standard features
- ▶ Advanced Protection
- ▶ Lifetime Limited Warranty

Step 1: Get Ideas

Jump-start your imagination with style and storage ideas for your new space.

- ▶ Kitchens

Step 2: Get Ready

Let's walk through a few things you should know and do before sitting down with a designer.

- ▶ Understanding the process
- ▶ Creating a budget
- ▶ Prioritize and personalize
- ▶ Layout planning
- ▶ Working with a designer

Step 3: Get Going

Start bringing your plan together. Explore the KraftMaid® cabinetry options that will make your kitchen everything you've ever wanted, inside and out.

- ▶ Finish options
- ▶ Wood types
- ▶ Door styles
- ▶ Decorative details
- ▶ Kitchen innovations
- ▶ Bathroom
- ▶ Rest of the house
- ▶ What's next?



Why KraftMaid®

You put a lot of thought into your kitchen, so we put a lot of care into making it. Plus, we include a host of standard features designed to stand up to real life and last for a lifetime.



Made just for you.

We build cabinetry for people. Not for kitchens. Especially not for store shelves. Each KraftMaid® cabinet is made by expert woodworkers and finished by skilled artisans according to your custom design plan. It's this hands-on care that gives your cabinets a one-of-a-kind beauty.



Quality comes standard.

A new kitchen is a big commitment. So you want to be confident you're making smart choices. Every cabinet we build comes with a host of standard features that make it dependably durable, so you can count on your KraftMaid Vantage® kitchen to look great and perform flawlessly over a lifetime of constant use.



DuraKraft™ Plus Finishing System

The first layer of our proprietary topcoat seals in your finish, while a thick, second layer protects from everyday scuffs and stains. Just wipe away the gunk and the worry.



All-Plywood Construction

This strong, stable material holds fasteners and joints tight, and resists swelling and warping from moisture.



Matching Interiors on Glass Doors

Attractive inside and out, the interior of glass door cabinets is finished to match the exterior – a detail that typically costs extra.



Solid-Wood Dovetail Drawers

This sturdy joinery is capable of withstanding generations of use. You'll find it on all four sides of a KraftMaid® drawer.



Soft-Close Drawers and Doors

Keep the peace in a busy kitchen or on a midnight snack run with Whisper Touch® soft-close hinges and slides.



I-Beam Construction

Your cabinets will stay strong, stable and square during delivery, throughout installation and beyond.



3/4" Solid-Wood Frames with Eased Edges

Soft edges reduce the risk of snags and scratches, plus help the wood better hold your choice of finish.



Deep Drawer Boxes with Full-Extension Drawers

Load up on more things. Even oddly shaped utensils and economy-size boxes. Then find what you need with ease because the drawers extend beyond the cabinet face.



90-lb Drawer Slides

Heavy jars? Grandma's cast-iron grill press? Socket set? No problem. Your drawers will stand up to just about anything you put in them.

[!\[\]\(1f56542a42e2413e44a2b2023033aa2e_img.jpg\) See how KraftMaid® cabinets get made.](#)

Advanced protection.

We build your cabinets with how you'll use them in mind – making sure they'll hold up to sticky hands, heavy pans and careless teenagers. But we don't stop there. We're always thinking of new ways to address other problems, like leaking faucets and seasonal humidity, too.





EverCore®

What you'll see is a particularly smooth painted finish. What you won't is any hairline separation at door frame joints or center panels. That's because EverCore® doesn't swell or shrink with temperature and humidity like milled wood.

[▶ More about EverCore®](#)



CoreGuard® Sink Base

Behind the wood frame and doors that match the rest of your cabinetry, you'll find a durable, easy-to-clean, engineered polymer cabinet designed to resist stains and damage from minor leaks and spills.

[▶ More about the CoreGuard® Sink Base](#)

Built for a lifetime of real living. We promise.

KraftMaid

LIFETIME
LIMITED
WARRANTY

KraftMaid Cabinetry warrants that its cabinets are free of defects in material or workmanship for as long as you own them. If at any point you have questions or need help, just call our Customer Care specialists at 1-888-562-7744.

➤ [Read our Lifetime Limited Warranty in its entirety.](#)



CABINETS: Breslin | EverCore® | Dove White ○ ISLAND: Breslin | Maple | Cannon Grey ●

Expect more. We do.

Our high standard of testing makes certain you won't be disappointed.

Test	KraftMaid requirements
Drawer guide	Tested for 35,000 cycles.
Door hinge	Tested for 35,000 cycles.
Chemical resistance	We test those 10 products plus another 38 – including beet juice, crayons, lipstick and name-brand cleaners.
UV light	We put finished doors and frames under intense UV light for 400 hours to ensure there won't be any unreasonable color changes after years of sun exposure.
High heat	We raise the temperature to 160°F.

[▶ Learn more about our extensive product testing.](#)





UPPER CABINETS: Ferguson | Oak | Translucent Monument Grey ●

LOWER CABINETS: Avery | EverCore® | Greyloft ●



Get Ideas

Your starting point for endless possibilities.

What will inspire you? An unexpected color combination? A storage feature that would make life so much easier? Maybe it's the thought of having a space dedicated just for cleaning up the fresh veggies and blooms you harvested from your garden.

Now's the time to set your vision. Start exploring kitchens, like the latest KraftMaid® cabinetry designs featured on the following pages, for ideas you'd like to include in your project. If you can imagine it, KraftMaid Cabinetry can help you make it happen.

▶ **Find more kitchens and save your favorites.**

STEP **1**



STYLE: TRANSITIONAL

Family Dynamic

Active meets attractive. Dedicated work zones in every corner of the U-shaped layout and a large center island are built to keep a busy household running. Clean lines and a classic white and grey palette give the room a comfortably casual feel that fits the times.



CABINETS: Breslin | EverCore | Dove White ● ISLAND: Breslin | Maple | Cannon Grey ●



Tall Pantry Pull-out



Utility Combination Cabinet



Mudroom Drop Zone



Utility Stack Pantry



PAINTED CABINETS: Sedona | EverCore® | Crimson **NEW** ● STAINED CABINETS: Sedona | Hickory | Slate ●



STYLE: CONTEMPORARY

Dramatic Flare

Spicy Crimson accents intensify the high-end, Euro styling while the streaked grain of Hickory doors telegraphs through the dark stain to add a hint of intrigue. A butler's pantry with ample wine storage is a dream for the connoisseur who wants to have favorites from the collection close at hand.



Wall Hood Box Plain



Wine Storage

Even with a collection worth cellaring, you put your passion for wine on full display.



Built-In Desk



Butler's Pantry



CABINETS: Bowen | Maple | Shortbread **NEW** ● ISLAND: Bowen | Maple | Greyloft ●
HUTCH: Lyndale | Maple | Onyx ●



STYLE: TRADITIONAL

Cherished Heritage

There's a touch of nostalgia in the raised panel doors and hutch. Everything else in this kitchen is designed for modern times – including maximized storage from stacked wall cabinets and a baking station that's cleverly hidden behind full-height pantry doors.



Hoosier Cabinet/Baking Station

It's easy to get rolling when you've got a hardworking baking station as your hidden secret.



Furniture Hutch



Walk-Through Pantry Doors

Disguise storage, even an entire room, in uninterrupted style.



Library

Bowen | Maple | Urban Grey ●



STYLE: TRANSITIONAL

Poised and Polished

From the mirrored pantry to the brushed brass hardware, this kitchen has just the right amount of glamour for an upscale feel that's not over the top. A lighter, contrasting finish on the island and hood establishes an eye-catching central focal point in a room with a corner sink.



CABINETS: Harrington | Maple | Overcast **NEW** ● ISLAND AND HOOD: Harrington | Maple | Moonshine ●



PAINTED CABINETS: Breslin | Maple | Rainfall ● STAINED CABINETS: Breslin | Cherry | Saddle ●



STYLE: TRANSITIONAL

Classic Creativity

Traditional details, like crown molding and furniture-style island legs, pair with a punch of bright blue color and contemporary accents to give this space an eclectic energy. The built-in coffee bar near the breakfast banquette is an eye-opener.



PAINTED CABINETS: Breslin | Maple | Rainfall ● STAINED CABINETS: Breslin | Cherry | Saddle ●



Pedestal Door Cabinet

Bench seating does double duty when there's easy-access storage below.



Coffee Bar

Enjoy an anytime pick-me-up without the stand-in-line wait.



Empire Corbel

Decorative brackets below countertops or cabinets add visual interest above and beyond the norm.



CABINETS: Marquette | Hickory | Translucent Limestone ● ISLAND: Marquette | Maple | Molasses ●



STYLE: TRADITIONAL

The New Traditional

A classic kitchen doesn't have to feel stuffy. Raised panel doors and stained finishes showcase traditional styling, but open shelving and a unique translucent cabinet finish with a contrasting island balance out the formality.



CABINETS: Marquette | Hickory | Translucent Limestone ● ISLAND: Marquette | Maple | Molasses ●



Tiered Plastic Storage

With different-sized cubbies, all those different-sized food storage containers will stay better contained.



Oven Cabinet with Deep Bakeware Drawer

Divided drawer storage lines up cookie trays and cake pans by the (baker's) dozen.



Step Stool Pull-Out

Having a step stool within easy reach puts everything else in the kitchen within easy reach.

STYLE: RUSTIC

Homegrown Character

Including a sink for rinsing just-picked backyard goodies is a natural in a farmhouse-inspired kitchen. But the real charm comes from blending rustic design elements, like shiplap walls and a furniture-style china hutch, with a more sophisticated cabinet style in both warm white and Distressed stain finishes.



PAINTED CABINETS: Elias | Maple | Cottage ● STAINED CABINETS: Elias | Cherry | Aged Bourbon ●





CABINETS: Elias | Cherry | Aged Bourbon ●



Wall Countertop Storage

Extended-height wall cabinet stretches to bring storage down to the counter.



Herb Station

A second sink near the back door comes in handy for cleaning veggies, flowers and the dirty hands that pick them.



Hutch

The look of antique furniture with the luxury of soft-close doors and drawers.

STYLE: TRANSITIONAL
Center of Attention



CABINETS: Garrison | Maple | Warm White ● ISLAND: Garrison | Maple | Riverbed ●

STYLE: TRANSITIONAL
Natural Appeal



CABINETS: Brookfield | Oak | Translucent Driftwood ●
ISLAND AND HOOD: Lyndale | Maple | Riverbed ●

STYLE: TRADITIONAL
Everyday Elegance



CABINETS: Fox Chase | EverCore® | Dove White ○ ISLAND: Fox Chase | Cherry | Baltic ●

STYLE: CONTEMPORARY
Hip Hive



UPPER CABINETS: Ferguson | Oak | Translucent Monument Grey ●

LOWER CABINETS: Avery | EverCore | Greyloft ●

STYLE: CONTEMPORARY
Open Invitation



ISLAND: Bowen | Maple | Cottage ● PENINSULA: Bowen | Maple | Molasses ●

STYLE: TRANSITIONAL
Seaside Vibes



CABINETS: Cornell | Maple | Lagoon ● ISLAND AND HOOD: Durango | Maple | Moonshine ●

STYLE: CONTEMPORARY
Mint Condition



CABINETS: Shepparton | Maple | Serenity ●

STYLE: TRANSITIONAL
Mid-Century Remixed



CABINETS: Hallett | Maple | Weathered River Rock ● PENINSULA: Hallett | Cherry | Husk ●

STYLE: RUSTIC
Farmhouse Fresh



CABINETS: Seton | Maple | Aged Picket Fence ISLAND: Seton | Maple | Serenity

STYLE: TRANSITIONAL
Colorful Outlook



CABINETS: Jovana | Maple | Harbor ● PENINSULA: Jovana | Cherry | Husk ●

STYLE: TRADITIONAL
Natural Charm



CABINETS: Durango | Maple | Barley ● Durango | EverCore® | English Green ●
ISLAND: Durango | EverCore | Riverbed ●



PAINTED CABINETS: Elias | Maple | Cottage ● STAINED CABINETS: Elias | Cherry | Aged Bourbon ●



Get Ready

How do you start designing the ideal kitchen? You already have.

If you've been thinking about a new kitchen for a while, you might already have an idea of what it will be like. Or at least you've figured out the nagging problems of your current space that you want to fix. Either way, you've already taken steps to get the KraftMaid kitchen you'll love.

You still have a lot of decisions to make before it all becomes a reality. Don't worry. We've got tools and tips to help you get organized, stay focused and be better prepared to sit down with a Kitchen designer to plan your kitchen.

STEP **2**

Know what to expect.

How does a kitchen come together? And how soon can you have it? Get familiar with the basic steps you'll go through to complete your kitchen remodel.



Plan

Typical Time Frame:
As long as you need

- Cabinets 101 ▶
- Gather ideas ▶
- Set a budget ▶
- Take measurements
- Meet with a kitchen designer ▶
- Refine design plans
- Get contractor quotes

PLAN TIPS:

Revise and adjust your design plan as many times as it takes. It's easier and far less expensive to try out ideas on paper than it is to change course after you order materials and begin construction.



Order

Typical Time Frame:
4-6 weeks

- Order cabinets ▶
- Purchase fixtures, flooring and appliances
- Box up your dishes
- Set up a temporary kitchen

ORDER TIPS:

Your cabinets will take a minimum of 4 weeks to arrive. While you're waiting, plan ahead for life during construction. What meals can you make with a slow cooker? Where will your kids eat? How will you keep pets safe?



Construction

Typical Time Frame:
A few days-2 weeks

- Demo
- Plumbing, electric and HVAC rough-in
- Drywall and painting

CONSTRUCTION TIPS:

Demolition is dirty and dusty. Protect floors and walls leading to and from your kitchen. Expect surprises and delays in this phase. They're part of every remodeling project.

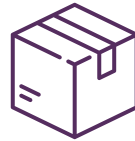

Installation

Typical Time Frame:
4-6 weeks

- Cabinets arrive ▶
- Inspect your order for any shipping damage
- Lay flooring
- Install cabinets
- Measure for countertops
- Install countertops
- Install lighting, faucets, backsplash and hardware
- Complete finish carpentry
- Review care and cleaning tips ▶

INSTALLATION TIPS:

Keep a keen eye out for the inevitable scuff or touch-up and note those on a punch list of fixes for your contractor.

The big question: What does a new kitchen cost?

Cost is the most common and often the most uncomfortable question for anyone considering a kitchen remodel. Use this page to help you make sense of the numbers.



CABINETS: Jamison | Maple | Moonshine ●



HOW LONG WILL IT TAKE?

Learn more about the four phases of a kitchen remodel and the typical time frame for each.

Set a ballpark budget.

A common rule of thumb is to invest 15% of your home's value in your kitchen remodel. Multiply the market value of your home by .15 to calculate this figure.

Keep project scope in mind. Are you happy with how your kitchen works, but want an updated look? Maybe you won't spend 15%. Expanding into that little-used dining room? You might need to set aside more for that. Consider different percentages that make the most sense for you.

YOUR HOME VALUE:

\$ _____

YOUR BALLPARK BUDGET:

X .	=	\$ _____
X .15	=	\$ _____
X .	=	\$ _____

Work out the cost breakdown.

It's helpful to understand how much you can expect to spend on each aspect of your project. (Fine-tune subtotals as you see fit. For instance, if you keep your existing appliances, you can use that money for upgrades in a different category.)

Multiply your ballpark budget by the following:

CABINETS	X .40	=	\$ _____
COUNTERTOP	X .13	=	\$ _____
APPLIANCES	X .12	=	\$ _____
FAUCETS, SINKS AND PLUMBING	X .04	=	\$ _____
FLOORING	X .04	=	\$ _____
LIGHTING AND ELECTRICAL	X .04	=	\$ _____
WALL TREATMENT AND TRIM	X .03	=	\$ _____
LABOR AND CONTINGENCY (Unexpected Expenses)	X .20	=	\$ _____

Want to try more advanced, interactive budgeting tools?



BUDGETING TOOLS

Ways to save.

Renovating the kitchen is one of the best ways to improve both the value of your home and the time you spend there. And while your remodeling project may be a significant investment, there are many ways to cut costs without sacrificing your vision.



SAVINGS GUIDE



CABINETS: Harrington | Maple | Canvas ●

WHAT'S THE ROI?

Homeowners have recouped up to 62% of their kitchen investment in improved resale value.

(Source: *Remodeling. 2019 Cost vs. Value Report.*)



Keep your layout.

Costs balloon when you add windows, remove walls and relocate plumbing, gas or electric lines. Explore ways to make improvements without significant changes to your existing space.

Look for affordable alternatives.

Ask your Kitchen designer about material options that give you the look you want for less:

- Choosing a door with veneer panels rather than a comparable style in solid wood will cut costs without dramatically changing the look of your space.
- You can get the appearance and character of hardwood floors in laminate, engineered hardwood or even tile.
- Design choices don't have to be all or nothing. For instance, consider budget-friendly butcher block on the perimeter counters, but splurge for quartz on your feature island.

Consider updates in phases.

Maybe your appliances are still in good working order. Make that a future upgrade. Or add the tile backsplash next year. You won't necessarily reduce your overall costs, but you'll spread out your expenses over time.

Ship smart.

While it makes sense to have a room full of cabinets delivered directly to your home, you might save money if you have other materials, like fixtures and flooring, shipped to the store for you or your installer to pick up.

Time it right.

Contractors are generally busiest in the summer and the months leading up to the holidays. You may find a better deal on labor if you schedule your work just after the new year.

A kitchen that's built around you.

The real beauty of a kitchen comes through in how it works. Since everyone uses their kitchen differently, now is the time to think about how you will live in yours. Use this worksheet to help prioritize what matters most to you.

Entertaining

Areas for seating and space to congregate.

Less Important More Important

Storage

Everything is orderly and organized.

Less Important More Important

Home Chef

Designed for serious cooks and gourmet meals.

Less Important More Important

Baking

Fresh-baked cookies, anyone?

Less Important More Important

Crafts & Homework

Room for projects and paperwork.

Less Important More Important

Family-Friendly

Kid zones and spaces just for furry family members.

Less Important More Important

Electronics

A space that's plugged in to modern living.

Less Important More Important



PERSONALIZE YOUR SPACE

Now that you've thought more about how you'll use your new kitchen, imagine having a space that's built around the activities you love. A place to share a meal, a drink or an important reminder – KraftMaid Cabinetry and your Lowe's® Cabinet Specialist can make it happen.



Flip the page for more personalized spaces.



Library

Carve out private space to conduct business, tackle the household finances or crack open a best seller.



Message Center

Never again have to ask, “Where are my keys?” or “What time is the softball game?”



Coffee Station

Centralize coffee-making activity so it's easy to get caffeinated when you're still half asleep.



Dining Room

Think beyond wall art. Showcase your prized china or display mementos from time spent abroad. It makes for interesting dinner conversations.



Mudroom Drop Zone

Drop gear, packages and notes for your family at a handy spot near your most often used door.



Baking Station

Baking is fun. Putting everything away, not so much. So keep everything handy with the ability to quickly stash it all away once the cake is in the oven.

How to measure your space.

Take basic measurements of your existing kitchen so your designer can design a floor plan that makes the most sense for your space and your vision.

1. Sketch out an outline of your kitchen. Label each wall with a number or letter for easier reference in future design and planning discussions. Precise scale isn't important.
2. Mark the general location of any windows, door openings and obstructions like radiators or structural posts.
3. Mark the general location of your sink and range.
4. Grab a tape measure and measure the full width of each wall from corner to corner. Jot down the measurements (in inches) on your drawing.
5. After you've measured the overall width, go back and measure the locations of all the openings and obstructions you've already marked.
 - Measure windows and doors from the outside edge of the trim on one side to the outside edge of trim on the other. Note the height of each opening as well.
 - Also measure from the nearest wall/corner to the center of each window and door.
6. Locate any utilities, like water supply and drain lines, gas lines, electric outlets and HVAC vents. If you can't see the gas line behind the range, for example, measure to the center of the range. The gas line will be located nearby.
7. Finally, measure the height of your room. If you have soffits, the part of the ceiling that drops down to meet the top of your wall cabinets, get both floor-to-ceiling and floor-to-soffit measurements.
8. When you're done with measurements, take pictures of each wall and closer shots detailing any obstructions. This helps your designer visualize the things you've noted on your drawing.



MEASURING
HOW-TO VIDEO



MEASURING
CHECKLIST

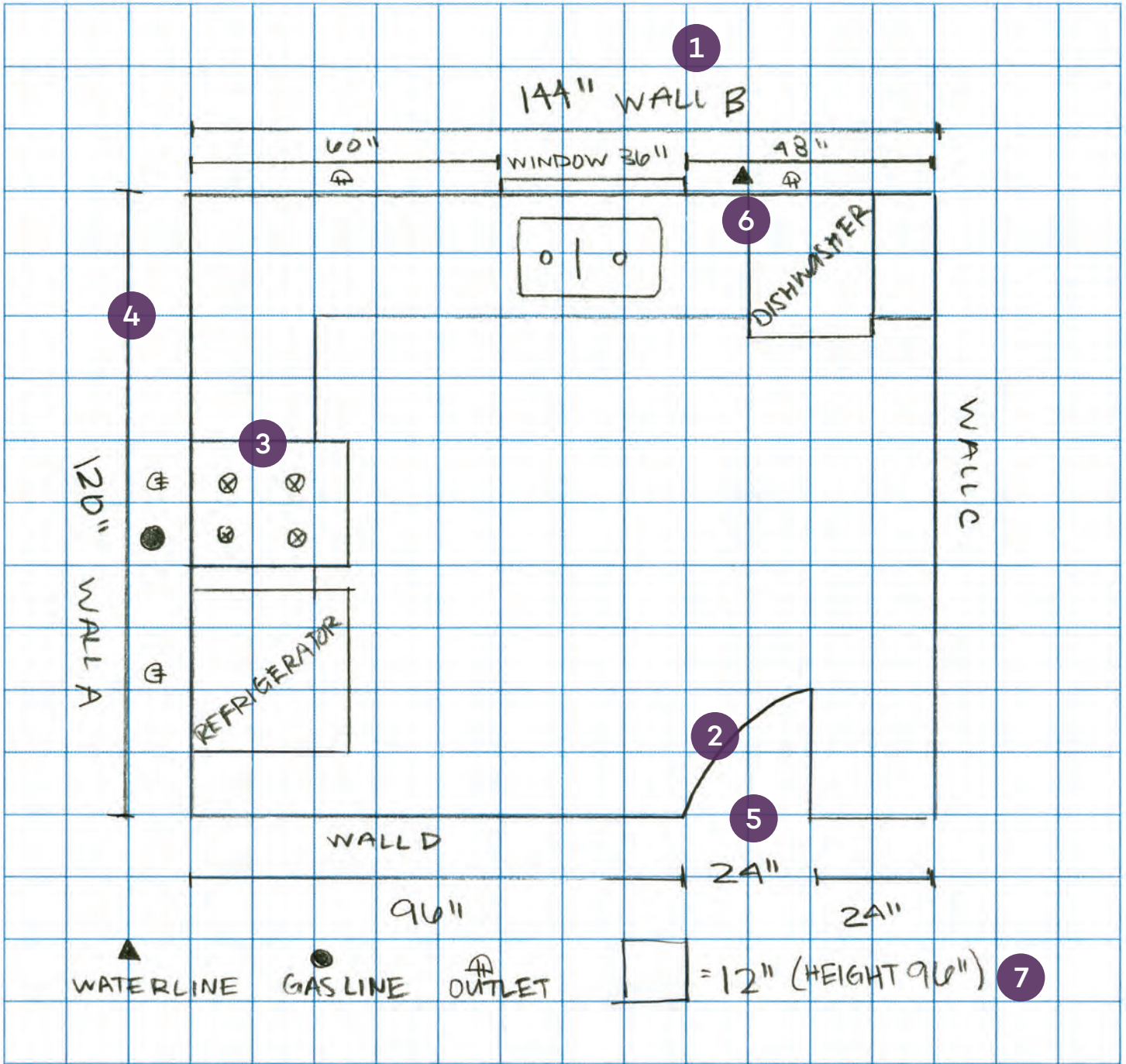

A WORD ABOUT ACCURACY.

Your rough measurements are just that, rough. Double-check your numbers and be as specific as you can on your sketch. But be sure to talk to your kitchen designer about getting professional measurements before you place your final order.

Put your plans in motion.

What can you expect when you work with a kitchen designer? Frankly, a lot. Your kitchen designer is a professional who can add value at every step of your project.





Advice and ideas.

Every day, kitchen designers guide people through this process. They know their way around a kitchen, so they can point out ways to balance your budget with your wish list, improve overall functionality, and help you avoid common (and costly) mistakes. All they need is the chance to get to know you and your needs.

Planning and design services.

You'll never regret having professional assistance to create your kitchen design plan. Your kitchen designer can map out your entire space down to the last detail – maximizing storage, optimizing work zones and adding finishing touches to make the style statement you're seeking.

Product selection.

Your kitchen designer knows KraftMaid® cabinetry inside and out. So they're the perfect resource to identify the door styles, finish options and storage innovations that will combine to become your dream kitchen.

Bringing your plan to life.

Don't just imagine what your new space will look like. Your kitchen designer can show you a 3D rendering of your plan – complete with your chosen door style and finish option.

Confidence.

Working with a design professional takes guesswork out of placing an order. Your kitchen designer knows the kind of details, like toe kicks, fillers and end panels, you'll need to include to make your final installation complete.

- > Schedule a kitchen design appointment at a local KraftMaid dealer.**

Checklist: Seven things to do before you meet with a kitchen designer.



1. Gather ideas.

Help your kitchen designer better understand your vision by collecting photos that inspire you and sharing your priority worksheet results from page 58.

2. Consider what's changing. (And what's not.)

You're not committing to anything just yet. But go in with an idea of your preferred layout and any appliance upgrades you'd like.

3. Snap pics of your existing kitchen.

Images allow your kitchen designer to get a better sense of your space. So take several from multiple angles.

4. Get rough measurements.

Bring a sketch of your space to begin discussions about possible design plans. Find measuring tips on pages 49-50.

5. Establish a ballpark budget.

Be prepared to have an upfront conversation about numbers. Use the ballpark budget calculator on page 42 for assistance.

6. Define your target timeline.

Tell your kitchen designer if you're trying to complete your project by a certain date or event.

7. Make an appointment.

Schedule time to have an initial conversation about your project with a kitchen designer.



MEASURING
CHECKLIST



LOCATE YOUR NEAREST
KRAFTMAID DEALER®



CABINETS: Fox Chase | EverCore® | Dove White ○ ISLAND: Fox Chase | Cherry | Baltic ●



Get Going

A kitchen that's you, down to the last detail.

What's the most exciting part about designing a new kitchen? Putting your personality into it.

From colors and door styles to organizational solutions and decorative details, you'll find plenty of ways to customize your design. Every option is inspired by real people and what they want in a kitchen, whether it's a style trend or a specific storage feature.

So let's dive in and find the right combination to make your space one-of-a-kind and one hundred percent you.

STEP **3**

Let's talk style.

There are three primary factors that drive the overall appearance of your kitchen:

➤ **Finish Options**

PAINTS | STAINS | SPECIALTY FINISHES | FOILS

The finish you select will likely have the biggest influence on the look of your space. Find the perfect choice (or choices) to dress up your space

➤ **Wood Types**

Choosing a type of wood goes hand-in-hand with choosing a finish. Each species has different characteristics that your finish choice will accentuate (or disguise).

➤ **Door Styles**

Smooth slab doors make for a sleek, contemporary look. Ornate raised panel doors fit traditional designs. Versatile Shaker-style doors can fit any kitchen in between.



Finish Options



Wood Types



Door Styles



Paints

Several coats of durable enamel let you create a colorful expression.



CABINETS: Jovana | Maple | Harbor ● PENINSULA: Jovana | Cherry | Husk ●

Dove White



(D) (CI) (CO)

Warm White



(D)

Cottage



(D)

Canvas



(D) (CI) (CO) (O)

Serenity



Moonshine



(D) (CI) (CO)

Heron NEW



(D)

Pebble Grey



(D) (CO)

EverCore®

For an extra-smooth painted finish, we recommend choosing EverCore. Available on a variety of door styles, EverCore is made by super-compressing wood fibers, so it reacts less to temperature and humidity than milled wood, providing an especially stable surface for a painted finish.

Available technique options:

ⓐ = Cinder Highlight ⓑ = Cocoa Highlight Ⓓ = Distressed Technique

ⓐ = Onyx Highlight ⓐ = Sable Highlight

Overcast NEW



Rainfall



Bonsai



Lagoon



Greyloft



Harbor



Urban Grey NEW



Crimson NEW



Ⓓ ⓐ

English Green



Midnight

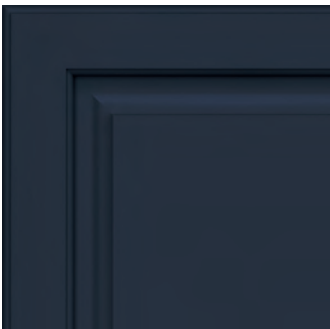

Riverbed



Onyx



Ⓓ ⓐ

Ⓓ

Finish Techniques: Paints with Highlight



Add beauty, depth and character by adding a specialty technique. Artisans apply highlight by hand to enhance visual depth and interest in the corners, crevices and ridges of each door style.

Cinder Highlight



Canvas with Cinder Highlight

Cocoa Highlight



Canvas with Cocoa Highlight

Onyx Highlight



Canvas with Onyx Highlight

Sable Highlight



Greyloft with Sable Highlight

Onyx Highlight



Midnight with Onyx Highlight

Need a closer look?



VIEW SAMPLES



ORDER A SAMPLE
CHIP OR DOOR

Sample cost is eligible for a rebate when you place your full kitchen order. (See website for details.)

Finish Techniques: Stains with Glaze



We add depth and dimension to the finish by flooding your stained door with glaze, then hand-wiping so glaze remains in crevices and grain lines.

Sable Glaze



**Ginger with
Sable Glaze**

Ebony Glaze

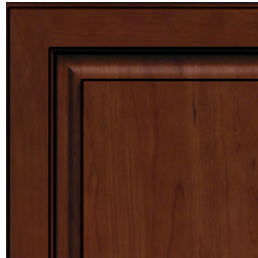

**Chocolate with
Ebony Glaze***

Need a closer look?



[VIEW SAMPLES](#)



[ORDER A SAMPLE
CHIP OR DOOR](#)

Sample cost is eligible for a rebate when you place your full kitchen order. (See website for details.)

Stains

Enhance the unique wood-grain character with hand-applied, hand-rubbed stains.



CABINETS: Fox Chase | Cherry | Baltic ●

Natural



Shortbread NEW



Honey Spice



Praline



Barley



Ginger



Husk*



Cognac



Chocolate*



(D) (E)

Baltic*



(D)

Molasses



(D)

Saddle



(D)

Brown Sugar NEW



(D)

Cannon Grey



(D)

Kaffé



(D)

Slate



(D)

Peppercorn



(D)

Available technique options:

(D) = Distressed Technique (E) = Ebony Glaze (SA) = Sable Glaze

All stains are shown on Maple unless marked otherwise.

* Shown on Cherry

Looking for something a little more unique? Consider a specialty finish for beauty that's out of the ordinary.



CABINETS: Marquette | Hickory | Translucent Limestone ● ISLAND: Marquette | Maple | Molasses ●

Translucent Finish

Color without concealing the character.

Get the color and brightness of paint while enhancing the natural beauty of wood like a stain. This hybrid finish allows just enough of the grain to come through.



Translucent Limestone



Maple



Oak



Hickory

Translucent Monument Grey



Maple



Oak



Hickory

Translucent Driftwood



Maple



Oak



Hickory

Translucent Monument Grey in Oak.

Weathered Finish

A timeworn appearance.

By using a dry brush technique to hand apply a finish on top of a base paint or stain, KraftMaid Cabinetry artisans create the look of wood that has been exposed to the elements for years. No two doors or drawers will be exactly the same.



Weathered Picket Fence



Maple



EverCore

Weathered Concrete



Maple



EverCore

Weathered River Rock



Maple



EverCore

Weathered Bourbon



Cherry

Aged Finish

The look of heirloom furniture.

Skilled artisans selectively sand, distress and burnish your cabinets to create the antique character of a kitchen that has served generations of families. Hand application of these techniques produces a random, inconsistent appearance that makes every door unique.



Aged Picket Fence



Maple

Aged Concrete



Maple

Aged River Rock



Maple

Aged Bourbon



Cherry



An alternative that's easy to love.

By using heat and pressure to fuse a solid-color foil to your cabinet doors, you can get a flawless, uniform and fade-resistant finish that can even take a light scrubbing. (Foil stands up well to humidity too, making them a smart choice for your mudroom, laundry and bath.)

If you're thinking modern, smooth high-gloss foil brings a contemporary, high-design feel to any kitchen.



Maxton

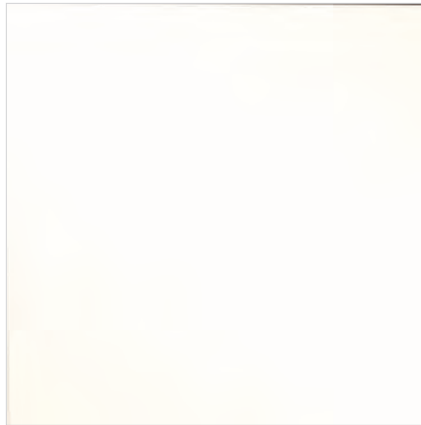

Dove White



CABINETS: Maxton | High-Gloss Foil | Dove White ●

Wood Types

The overall look of your cabinets comes from both the finish you choose and the type of wood it goes on. Stains and translucent finishes will influence the appearance of wood's naturally occurring color variations and grain patterns.



Alder

- Ranges from pale pink-brown to tan
- Features knotholes, burls and mineral streaks

Available only in Rustic.



Hickory

- Dramatic color contrasts from light cream to dark reddish-brown
- Random grain pattern with burls and knots



Cherry

- Reddish-brown hues that mellow (darken) over time
- Smooth, straight-grain pattern



Oak

- Light to medium brown
- Richly textured, wavy grain pattern



Maple

- Off-white with light, creamy hues of gold
- Consistent, fine grain with occasional dark mineral streaks



Rustic

- Naturally occurring knots, burls, wormholes and color variations from mineral streaks can make wood even more interesting

Rustic option is available on Alder, Hickory and Maple on select door styles.

EverCore®

Extra-smooth, extra-solid doors and drawer fronts, made by super-compressing wood fibers, react less to temperature and humidity than milled wood and provide an especially stable surface for a painted finish.

Available on a variety of door styles.



[← Back to page 11](#)

Door Styles



Some terms you're likely to hear.



Slab

A door with the look of a single piece of wood with no panel or decoration. Drawer fronts are also available as slab on many styles.



Shaker

It's a style term given to specific door styles that provide a clean, orderly and simple look.



Recessed Panel

A recessed panel style has a flat panel set back inside the frame of a door.

Each door option has unique characteristics that can give your kitchen a specific style. (We've arranged our doors from simple to ornate so it's easier to focus in on a look you might like. Your designer can help you find the right one for your design and your budget.)



Raised Panel

A raised panel door has a panel that rises in the center and is somewhat decorative.



Full Overlay

A full overlay has very little cabinet frame showing around each door and drawer front, creating a seamless look.



Half Overlay

A half overlay shows some cabinet frame around each door and drawer front.

Click to see our top-selling species and finish combinations in each door style.



Avery

C M E



Ferguson

C M O



Hallett*

C M E



Elias Full

C M



Elias Half

C M



Lyndale Full

A C H M O E

A = Alder C = Cherry H = Hickory M = Maple O = Oak E = EverCore®

(X) = Wood Type Shown (X) = Also Available On

● = Dealer Exclusive



Lyndale Half

A C H (M) O E



Grandview Square Full*

A C H (M) O E



Grandview Square Half*

A C H (M) O E



Renway*

C (M) E



Melrose*

O



Cornell

C (M)

Click to see our top-selling species and finish combinations in each door style.



Trumbull*

A C M O



Bowen

C M



Putnam*

A C M O



Sedona

A C H M O E



Jovana

C M



Shepparton

C M

A = Alder C = Cherry H = Hickory M = Maple O = Oak E = EverCore®

(X) = Wood Type Shown (X) = Also Available On

(●) = Dealer Exclusive



Amhurst*

(H) (M) (O)



Breslin

(C) (M) (E)



Brookfield*

(C) (H) (M) (O) (E)



Seton

(C) (M)



Durango*

(A) (C) (H) (M) (O) (E)



Garrison*

(C) (M)

Click to see our top-selling species and finish combinations in each door style.



Knollwood

C M E



Fox Chase Square Full*

C H M O E



Fox Chase Square Half*

C H M O E



Marquette Square Full*

A C H M O E



Marquette Square Half*

A C H M O E



Marquette Roman Full*

C H M O E

A = Alder C = Cherry H = Hickory M = Maple O = Oak E = EverCore®

(X) = Wood Type Shown (X) = Also Available On ● = Dealer Exclusive



Marquette Roman Half*

(C) (H) (M) (O) (E)



Harrington

(C) (M)



Chanlott

(C) (M)



Jamison

(C) (M)



Rutherford

(C) (M) ●



Vanderbilt

(C) (M)

Popular Door Styles

As you narrow in on a door style for your project, it may be inspiring to see some styles that are trending or perennial favorites.



Lyndale

Versatile. Classic. Clean-lined. What's not to love about this quintessential Shaker style?



Marquette

An ogee profile gives the raised center panel of Marquette a handsome, time-honored appearance.



Avery

This solid slab door is as streamlined and contemporary as you can get.



Durango*

The wider frame pairs with a wide reveal on the beveled center panel to update a classic.



Putnam*

A wider frame and a solid wood center panel amp up the luxury in this Shaker-inspired door.



Brookfield*

A beaded panel door looks great in a cottage or coastal setting. Glazes or highlights can accentuate the narrow grooves.

** shown with optional drawer front*

Decorative Door Options

Highlight a cabinet run or make a place to showcase special keepsakes.

See the complete offering of decorative door options at kraftmaid.com/door-inserts.



HUTCH: Lyndale | Maple | Onyx ● | Cascade Glass



Classic Camed Insert



Prism Insert



Moire Insert



Showcase Mullion



Satina Insert



Cascade Insert

Specialty Inserts

From textured glass to useful chalkboard, inserts give you the artistic freedom to make a style statement in your kitchen.



Aluminum Frames

Coupled with your choice of glass inserts, brushed aluminum frames add a touch of sparkle right where you want to attract attention.

Vetro Brushed Aluminum



SEE ALL DECORATIVE DOOR OPTIONS

Decorative Details



Knobs & Pulls

For such a relatively small item, your choice of hardware can dramatically change how the room feels: the choice of the metal, the size of the pull, and the style of the knob.

- 1 Brexler Knob
- 2 Keene Pull and Knob (Satin Nickel)
- 3 Callister (Statuary Bronze)
- 4 Bordeaux Pull
- 5 Sloan Pull
- 6 Galileo Pull (Statuary Bronze)
- 7 Belhaven Knob
- 8 Quantum Pull
- 9 Resolute Pull
- 10 Suitcase Pull (Chrome)
- 11 Forged Pull and Knobs

[▶ SEE ALL KNOBS](#)

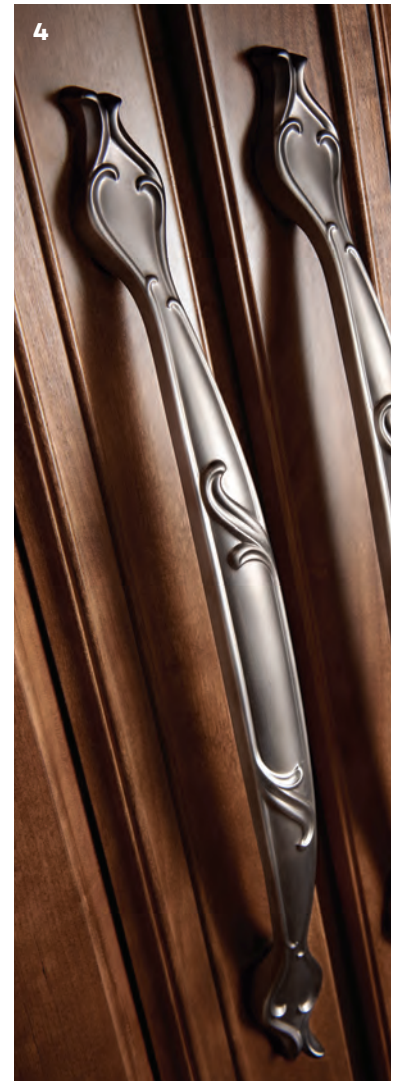

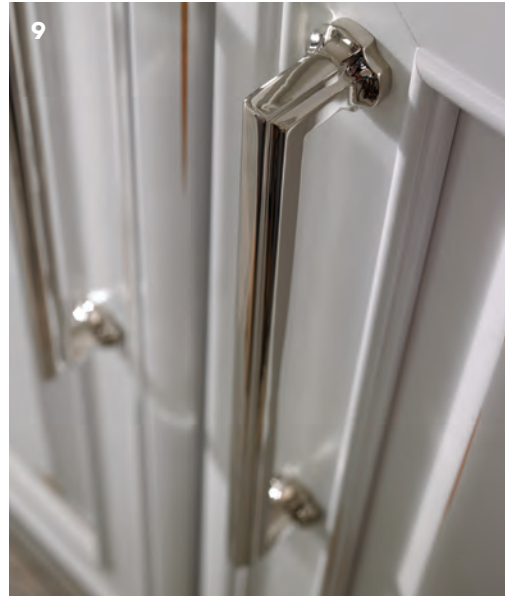



PAINTED CABINETS: Elias | Maple | Cottage ● STAINED CABINETS: Elias | Cherry | Aged Bourbon ●



Lighting & Molding

Lighting and molding can accent what you want people to notice and help hide the pipes, ducts, wiring and uneven surfaces you don't want them to see.

- 1 Large Empire Corbel
- 2 Under Cabinet Lighting
- 3 Above Cabinet Molding
- 4 In-Cabinet Lighting
- 5 Decorative End Panel

Kitchen Innovations

Of course, you'll love the look of your new kitchen. But you might love what you don't see even more. We've designed a place for everything – from step stools to coffee pods to phone chargers. You'll find plenty of clever ideas to make your kitchen work better for you.



CABINETS: Hallett | Maple | Riverbed ●



Corner Solutions

Every kitchen's inevitable corners take up so much space and, without the right solutions, turn into "where seldom-used items go to hide." The right innovation lets you store things like appliances or baking ingredients – and makes them easy to find and retrieve.

- 1 Easy Reach Chrome Super Susan
- 2 Easy Reach Wood Super Susan
- 3 Corner Drawer Cabinet
- 4 Blind Corner with Wood Lazy Susan
- 5 Blind Corner with Wood Swing-Out
- 6 Wall Angle Chrome Lazy Susan
- 7 Blind Corner with Chrome Swing-Out



Pull-Outs

Pull-outs are the most efficient use of limited space. They slide out to create reachable storage throughout the full depth of the cabinet, so even items at the back stay easily accessible.

- 1 Cleaning Supplies Pull-Out
- 2 Utensil Pull-Out
- 3 Tray Pull-Out
- 4 Pantry Pull-Out with Utensil Storage
- 5 Pantry Pull-Out
- 6 Wall Filler Pull-Out

Wastebasket Solutions

Trash is literally the last thing you want people to notice. Put the trash, recycling and compost behind closed doors and out of the way.

- 1 Sink Base Wastebasket
- 2 Slim Wastebasket
- 3 Top-Mount Wastebasket
- 4 Top-Mount Double Wastebasket



Spice Storage

Everyone has a cabinet or drawer they rummage through looking for the spice they need, but that's the last thing you want to do as the chicken burns and the water boils over. Keeping spices organized and within arm's reach of the stove makes cooking a little more seamless.

- 1 Door Spice Rack
- 2 Tiered Storage Shelf
- 3 Spice Drawer

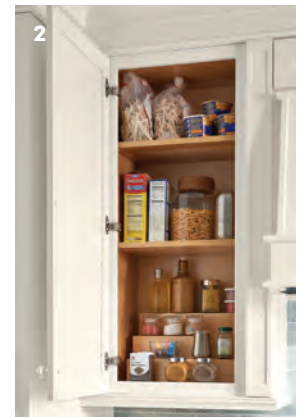



Pantry Storage

Maximize usable storage and bring gratifying organization to spaces that tend to get chaotic. Imagine: a kitchen world where everything has a place and nothing is abandoned in the back of the cabinet.

- 1 Wall Appliance Garage
- 2 Tall Pantry Roll-Out
- 3 Multi-Storage Pantry with Adjustable Shelves



Advanced Solutions

Engineering and technology come together in the kitchen. So now, for example, hide messy cords inside charging drawers, and make your mixer easy to lift with this raising mixer shelf.

- 1 Charging Drawer
- 2 Mixer Shelf

Roll-Out Trays

Bring everything into view from the back of any cabinet. Now the spring form pan, the baking mixes and all those one-use appliances won't get ignored simply because they're hard to get to.

- 1 Roll-Out Tray Divider
- 2, 3 Chrome Deluxe Roll-Out Trays
- 4 Sink Base Roll-Out Tray



Utensils

Corral forks, knives, cheese graters, measuring spoons, the set of corn cob holders shaped like corn, the slightly less whimsical corn cob holders, and anything else that has a shape, size, length, width or one-of-a-kind use that makes it apt to cause trouble in a drawer.



- 1 Tiered Combination Drawer
- 2 Angled Utensil Drawer Organizer
- 3 Tiered Drawer Storage
- 4 Cutlery Drawer
- 5 Knife Section Cutting Center





Smarter Drawers

Make the very best use of your kitchen by maximizing the storage space in--and even under--your cabinets. Drawers with tiered storage, and hidden toe kick drawers keep things easily accessible when you need them, and neatly tucked away when you don't.

- 1 Tiered Plasticware Storage
- 2 Toe Kick Drawer



Pots & Pans

Avoid an unwelcome game of "Find the Right Pan." No more rattling metal. No more misplaced lids. No more uncomfortable crouching as you attempt to retrieve the stock pot.

- 1 Oven Cabinet with Deep Bakeware Drawer Dividers
- 2 Adjustable Drawer Dividers
- 3 Cooking Center
- 4 Chrome Deluxe Roll-Out Trays
- 5 Pots and Pans Organizer
- 6 Pegged Drawer Organizer

Beyond Cooking Storage

A lot more than cooking happens in the kitchen, and that's natural, but food prep and other projects shouldn't compete for space. These solutions give non-cooking items a home, so they can stay in the kitchen without taking over.

- 1 Angled Drawer Organizer
- 2 Base Wine Storage
- 3 Message Center
- 4 Utility Cleaning Cabinet
- 5 6" Base Step Stool Pull-Out
- 6 File Cabinet Base





Design Solutions

Accents and statement pieces – some simply complement (or complete) the style you have going. Others manage to be stylish and useful too, whether it's a strategically placed floating shelf for handy wine glasses, or a way to make the island more welcoming.

- 1 Walk-In Pantry Corner
- 2 Recessed Panel Wall Hood
- 3 Floating Shelves
- 4 Transitional Island End
- 5 Bookcase Island End

CoreGuard® Sink Base

Beautiful style outside, lasting protection inside. Protect your cabinets from minor spills and leaks under the sink with the CoreGuard® Sink Base. Made of an engineered polymer that resists damage and stains, the CoreGuard Sink Base is built to last and easy to clean so it stays beautiful for as long as you own it.

- 1 CoreGuard Sink Base
- 2 CoreGuard Deep Sink Base



[← Back to page 11](#)

Bathroom

Why stop at the kitchen? You can create a bath that meets your unique style and storage needs, too. KraftMaid Cabinetry and your kitchen designer will make it easy.

➤ MORE BATH IDEAS



Lyndale | Rustic Alder | Shortbread **NEW** ●



Charlott | Maple | Canvas with Onyx Highlight ●



Jamison | Maple | Moonshine ●

Bath Innovations



Vanity Wood Tiered Drawer Storage



Vanity Top-Mount Hamper



Vanity Pull-Out Appliance Organizer

The Rest of the House

Thinking of remodeling other spaces in your home? We'll help you upgrade any room that could use more style and more storage.

[▶ EXPLORE IDEAS](#)



PAINTED CABINETS: Elias | Maple | Cottage ● STAINED CABINETS: Elias | Cherry | Aged Bourbon ●



Shepparton | Maple | Serenity ●



Ferguson | Oak | Translucent Monument Grey ●



Chanlott | Maple | Canvas ○



Bowen | Maple | Urban Grey **NEW** ●



Hallett | Maple | Riverbed ●



Breslin | EverCore® | Dove White ○



CABINETS: Seton | Maple | Aged Picket Fence ○ ISLAND: Seton | Maple | Serenity ●



Help from start to finish.

Your new kitchen is well within your reach because you've got KraftMaid Cabinetry, the number one name in cabinetry, to guide you along the way. If you ever feel stuck, just go back to Step 2 of this brochure to see what's next. You can visit kraftmaid.com/dealer for online planning tools that help you stay on track too.



PLANNING TOOLS

Before you know it, you'll be ready to sit down with a designer to get a kitchen designed just for you and just the way you imagined it would be.

If you need any other assistance, we're just a phone call away. KraftMaid Customer Care: 1-888-562-7744

Ready to put your design plan in motion?



GET IN TOUCH WITH A
KITCHEN DESIGNER



KraftMaid
VANTAGE®
KITCHENS FOR THE REAL LIVING ROOM®

© 2022 Cabinetworks Group Michigan, LLC. All Rights Reserved.

Specifications subject to change without notice.

The photography and color samples shown in this book have been reproduced as accurately as printing technologies permit and are for representation only. To ensure the highest satisfaction, we strongly recommend you view an actual product sample prior to ordering cabinetry.

kraftmaid.com/dealer